



Shown from left to right:  
EG-2510, EG-4010, EG-4016, EG-4025

## EG-SERIES High Pressure Gauges

- ◆ Calibrated with dual scale reading for MPa and PSI, Accuracy,  $\pm 1\%$ .
- ◆ Fast, easy to install.

- ◆ Made of corrosion resistant stainless steel.
- ◆ Aseismatic - not affected by motion.

Model	Pressure Range		Thread	Gauge Diameter
	bar	psi		
EG-2510	0-700	0-10000	1/4NPT	2.5
EG-4010	0-700	0-10000	1/2NPT	4
EG-4016	0-1600	0-23000	M20X1.5	4
EG-4025	0-2500	0-35000	M20X1.5	4

EGA-001/EGA-002

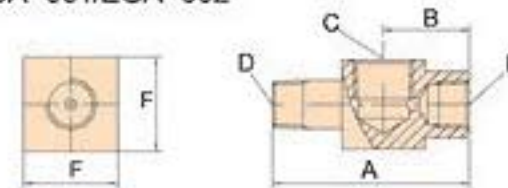

EGA-003/EGA-004/EGA-011

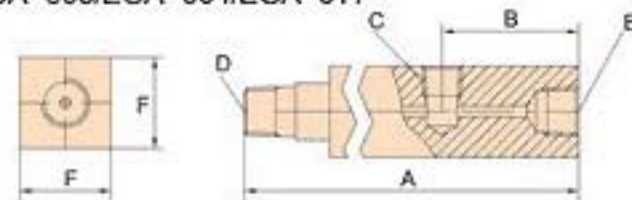

EGA-005

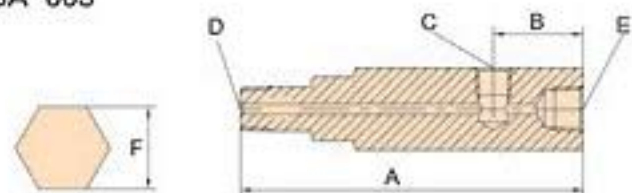

## EGA-SERIES Gauge Adaptors

- ◆ To adapt above gauges to hydraulic system.

Model	Female Coupler Thread	Male Coupler Thread	Gauge thread	Sizes(mm)					
				A	B	C	D	E	F
EGA-001	3/8"NPT	3/8"NPT	1/2"NPT	71	31	1/2"NPT	3/8"NPT	3/8"NPT	32
EGA-002	3/8"NPT	3/8"NPT	1/2"NPT	155	35	1/2"NPT	3/8"NPT	3/8"NPT	32
EGA-003	3/8"NPT	3/8"NPT	1/4"NPT	133	48	1/4"NPT	3/8"NPT	3/8"NPT	32
EGA-004	3/8"NPT	1/4"NPT	1/2"NPT	111	35	1/2"NPT	1/4"NPT	3/8"NPT	32
EGA-005	3/8"NPT	3/8"NPT	1/4"NPT	134	35	1/4"NPT	3/8"NPT	3/8"NPT	32
EGA-011	1/4"NPT	3/8"NPT	1/4"NPT	133	48	1/4"NPT	3/8"NPT	1/4"NPT	32